

The Riley RM Centre Information Slip

Assembly Hints for RM23(H) Water Pump Kits

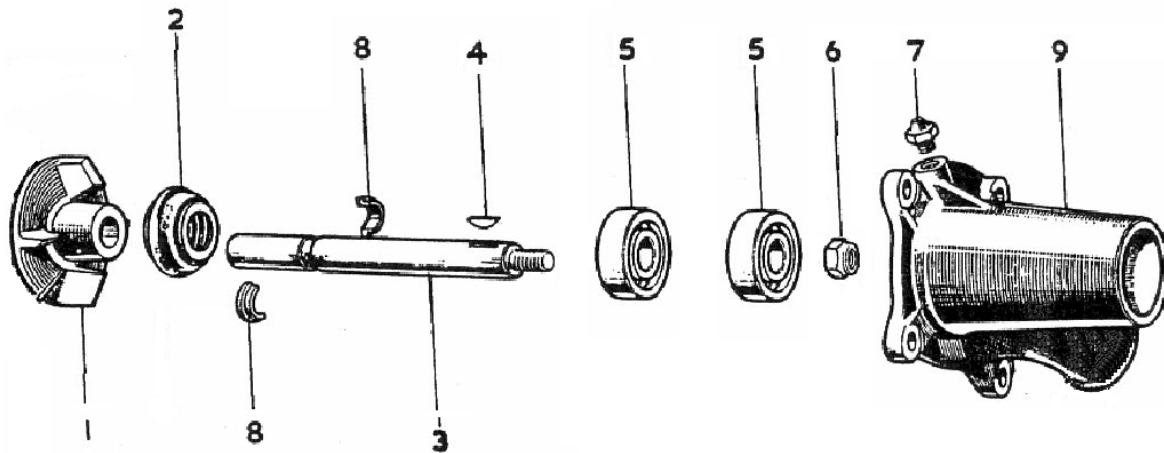

This kit contains items 1 to 7 items 8 and 9 are not available new from the Spares centre

The bearings as supplied are fitted with two shrouds, should you want to run in a “sealed for life” condition then leave them both in place. Alternatively you could remove one seal from each bearing which will allow periodic greasing. In such a condition the sealed end of the bearing should facing outwards ie away from the lubricant. The rear bearing shroud should face backwards and the front shroud should face forwards. This shroud replaces the original felt seals.

The ‘O’ ring fitted to the water seal is there to act as a spacer, care should be taken not to compress this ring too much on fitting it to its mounting. It is recommended that a small amount of sealant is used between the seal and its housing.

Please note, when assembling this water pump fit the impeller to the shaft aligning the pilot holes before drilling the holes out to 5/32” and fitting the Mills pin.

On first start up there may be a small amount of leakage from the pump seal until it beds in. This running process can be improved by a gentle lapping of the seal face on the impellor to remove any machining marks. Antifreeze can also act as a lubricant and slow the bedding process down.

The Riley RM Centre Ltd

THE RILEY R.M. CENTRE LTD						RM23H Assembly	A4
DRAWN	ISS	CHANGE	APP	DATE	NOTES		
SP	1			22/3/18		DWG NO. RM23H -IS	SHEET 1